

VILLAGE 2
SEE SHEET PU-2

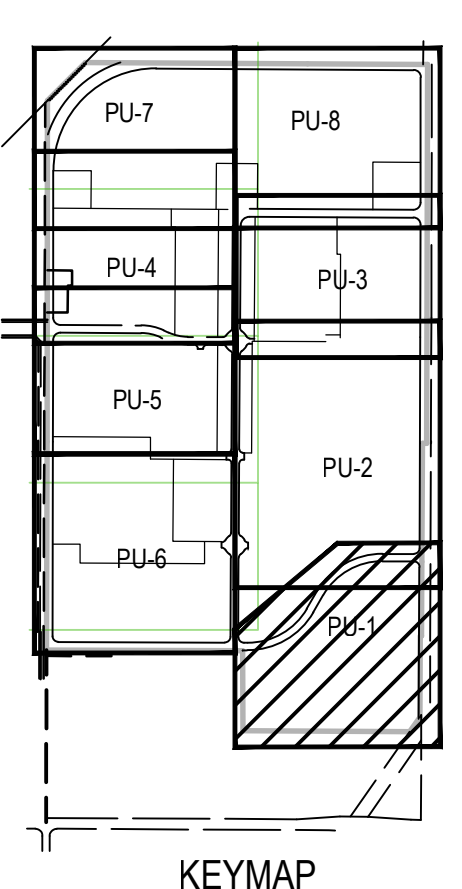
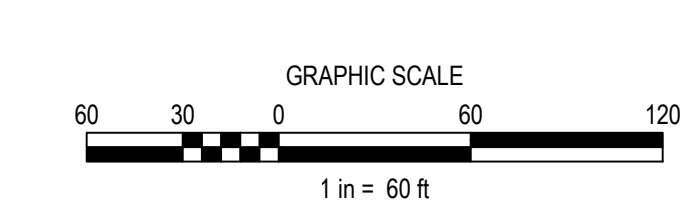

LEGEND

SYMBOLS:		DESCRIPTION
EXISTING	PROPOSED	
		STORM DRAIN PIPE & SIZE
		SANITARY SEWER PIPE & SIZE
		DOMESTIC WATER PIPE & SIZE
		FIRE PROTECTION WATER PIPE & SIZE
		NATURAL GAS PIPE & SIZE
		MANHOLE
		STORM DRAIN INLET
		CLEANOUT
		VALVE
		FIRE HYDRANT
		BLOW OFF VALVE

SCALE: 1" = 60'
HORIZ. 1" =
VERT. 1" =

BENCH MARK
7/8" METAL DISC STAMPED "00, B.M. 19-35"
LOCATED IN TOP OF S.E. END OF S.W. CONCRETE
HEADWALL OF CULVERT ACROSS THE SPRR, 5
APPROXIMATELY 50' N.E. OF CENTER OF
PLACERVILLE ROAD, N.E. OF OLD STATE CULVERT
APX=53.35 PACES N.W. OF MILEPOST 118 &
APPROXIMATELY 0.45 MILES N.W. OF U.S. ROUTE 50
(R.R. CULVERT BUILT IN 1916)

COMPUTED
DESIGNED
DRAWN
PROJ. ENGR.

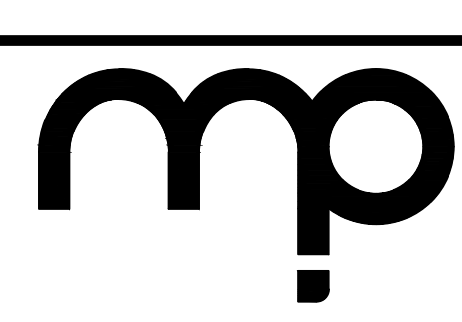

MORTON & PITALO, INC.
CIVIL ENGINEERING • LAND PLANNING • LAND SURVEYING
Folsom • Fresno
600 Coolidge Drive, Suite #140
Folsom, CA 95630
phone: (916) 994-7621
web: www.mpeaengr.com

THE CAMPUS @ DIXON
VILLAGE 1 - PRELIMINARY UTILITIES

DATE 03/11/2025
SHEET PU-1
OF 9

VILLAGE 2
SEE SHEET PU-3

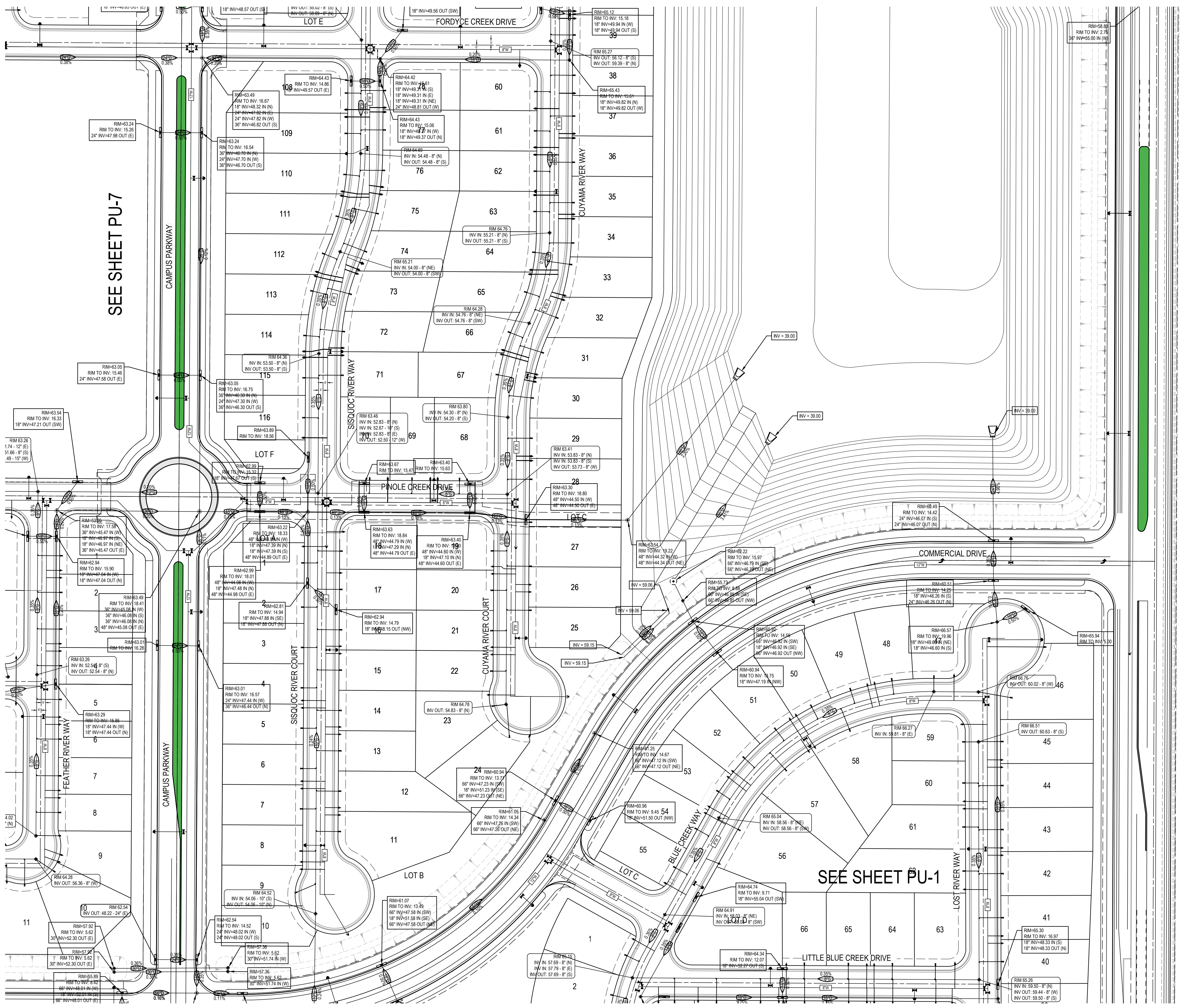

SEE SHEET PU-7

SEE SHEET PU-1

LEGEND

EXISTING	PROPOSED	DESCRIPTION
		STORM DRAIN PIPE & SIZE
		SANITARY SEWER PIPE & SIZE
		DOMESTIC WATER PIPE & SIZE
		FIRE PROTECTION WATER PIPE & SIZE
		NATURAL GAS PIPE & SIZE
		MANHOLE
		STORM DRAIN INLET
		CLEANOUT
		VALVE
		FIRE HYDRANT
		BLOW OFF VALVE

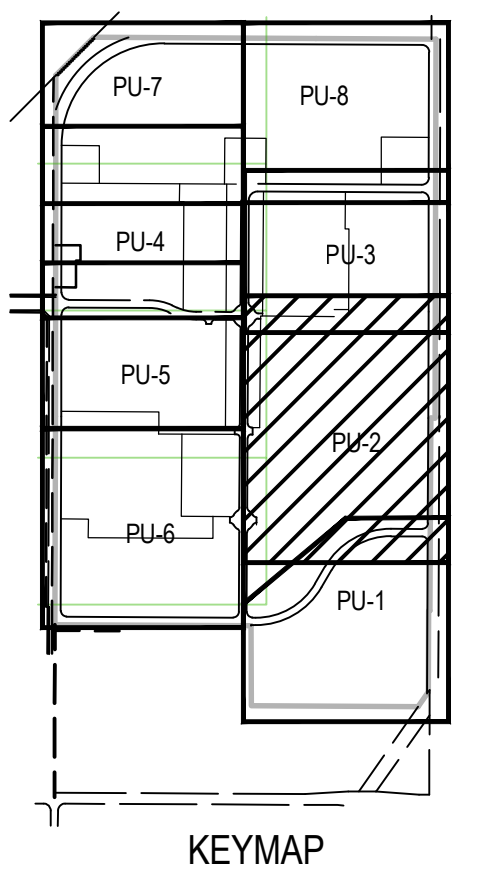
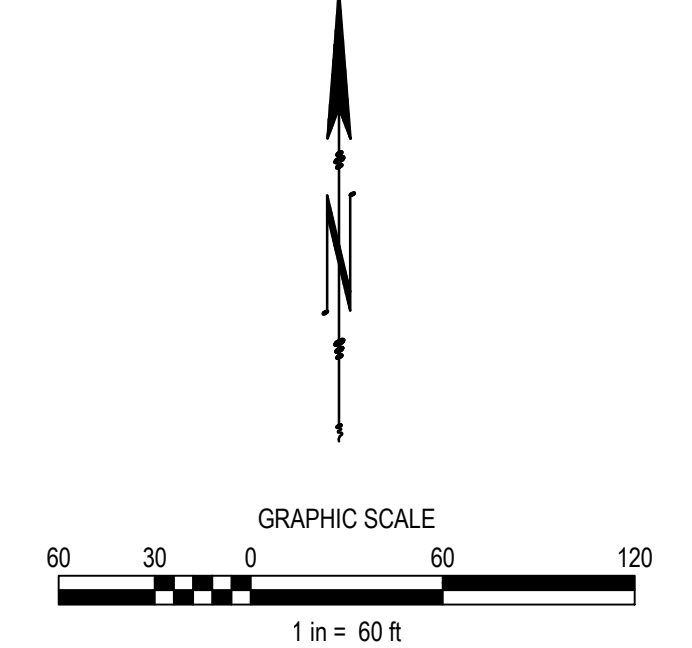

SCALE: 1" = 60'
 HORIZ. 1" =
 VERT. 1" =

BENCH MARK
 7/8" METAL DISC STAMPED "O.D. B.M. 19-35"
 LOCATED IN TOP OF S.E. END OF S.W. CONCRETE
 HEADWALL OF CULVERT ACROSS THE SPRR, 5
 APPROXIMATELY 50 N.E. OF CENTER OF TRACKS,
 APPROXIMATELY 35 PACES N.W. OF CENTER OF
 PLACERVILLE ROAD, N.E. OF OLD STATE CULVERT
 APPROX. 35 PACES N.W. OF MILEPOST 118 &
 APPROXIMATELY 0.45 MILES N.W. OF U.S. ROUTE 50
 (R.R. CULVERT BUILT IN 1916)

C.COMPUTED
 DESIGNED
 DRAWN
 PROJ. ENGR.

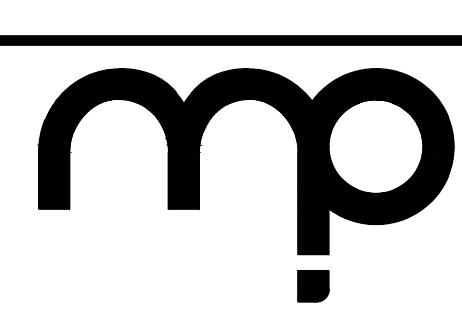

MORTON & PITALO, INC.
 CIVIL ENGINEERING • LAND PLANNING • LAND SURVEYING
 Folsom • Fresno
 600 Coolidge Drive, Suite #140
 Folsom, CA 95630
 phone: (916) 954-7621
 web: www.mpeinc.com

THE CAMPUS @ DIXON
 VILLAGE 1 - PRELIMINARY UTILITIES

DATE
 03/11/2025
 SHEET
 PU-2
 OF
 9

VILLAGE 3
SEE SHEET PU-4

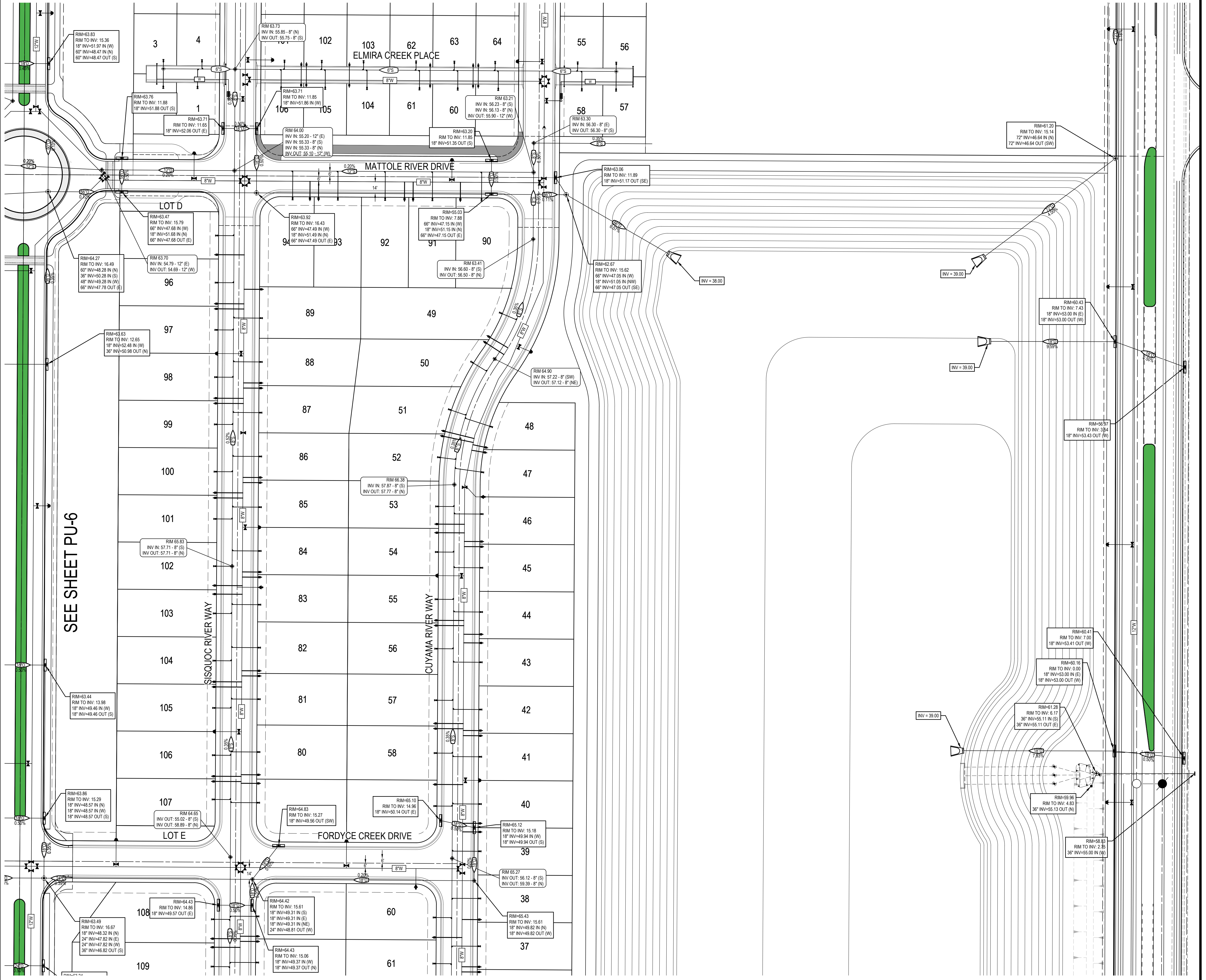

VILLAGE 2
SEE SHEET PU-2

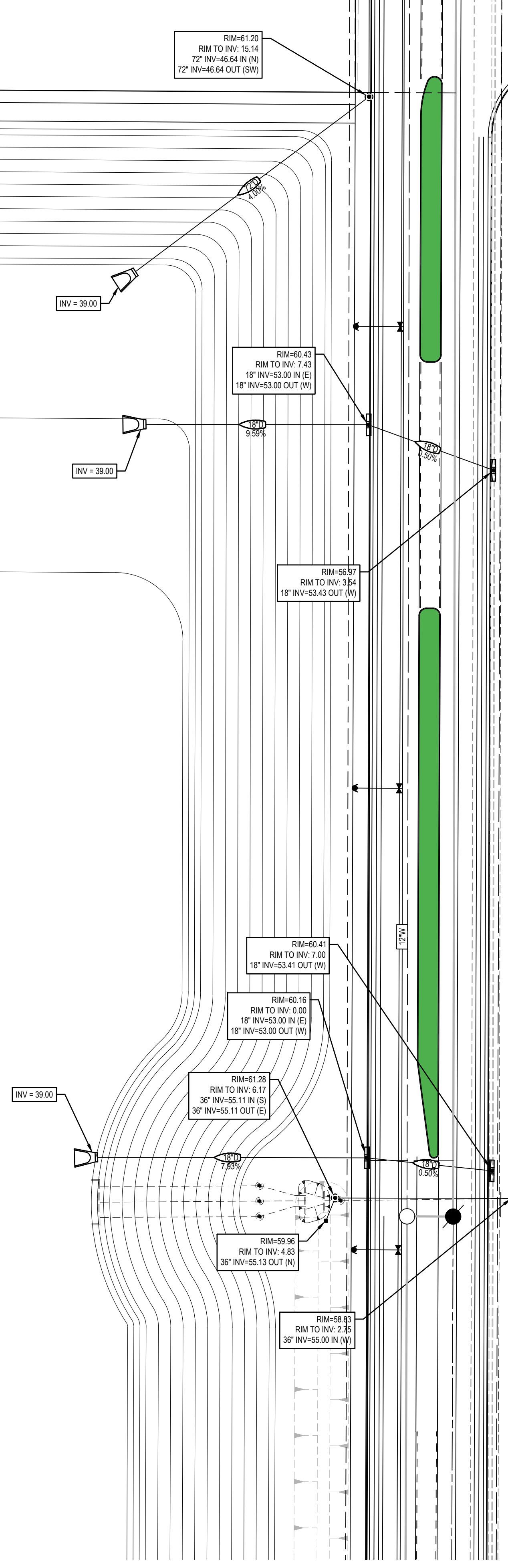

LEGEND

SYMBOLS:		DESCRIPTION
EXISTING	PROPOSED	
		STORM DRAIN PIPE & SIZE
		SANITARY SEWER PIPE & SIZE
		DOMESTIC WATER PIPE & SIZE
		FIRE PROTECTION WATER PIPE & SIZE
		NATURAL GAS PIPE & SIZE
		MANHOLE
		STORM DRAIN INLET
		CLEANOUT
		VALVE
		FIRE HYDRANT
		BLOW OFF VALVE

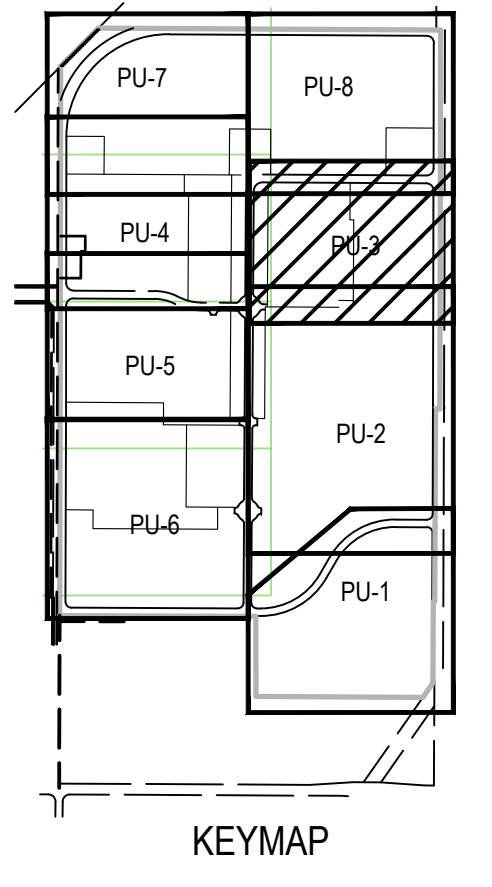
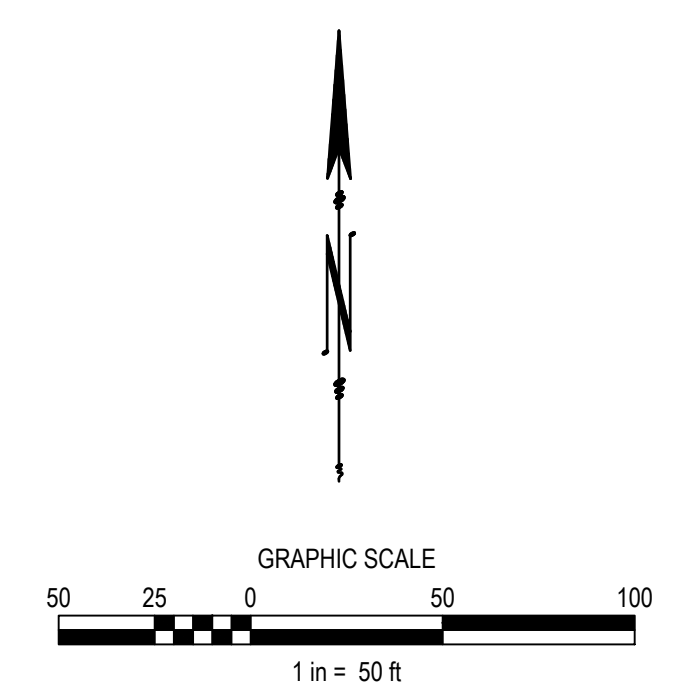

SCALE: 1" = 50'
 HORIZ. 1" =
 VERT. 1" =

BENCH MARK
 7/8" METAL DISC STAMPED "00, B.M. 19-35"
 LOCATED IN TOP OF S.E. END OF S.W. CONCRETE
 HEADWALL OF CULVERT ACROSS THE SPRR, S
 APPROXIMATELY 50' N.E. OF CENTER OF
 PLACERVILLE ROAD, N.E. OF OLD STATE CULVERT
 APPROXIMATELY 35' PAGES N.W. OF MILEPOST 118 &
 APPROXIMATELY 0.45 MILES N.W. OF U.S. ROUTE 50
 (R.R. CULVERT BUILT IN 1916)

COMPUTED
 DESIGNED
 DRAWN
 PROJ. ENGR.

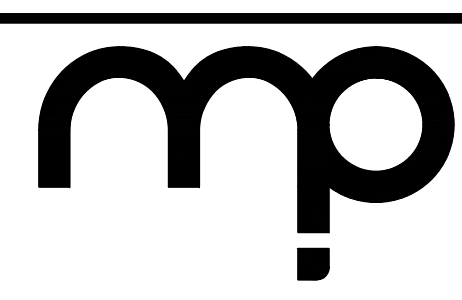

MORTON & PITALO, INC.
 CIVIL ENGINEERING • LAND PLANNING • LAND SURVEYING
 Folsom • Fresno

600 Coolidge Drive, Suite #140
 Folsom, CA 95630
 phone: (916) 954-7621
 web: www.mpengr.com

THE CAMPUS @ DIXON
 VILLAGE 2 - PRELIMINARY UTILITIES

DATE
 03/11/2025
 SHEET
 PU-3
 OF
 9

SEE SHEET PU-9

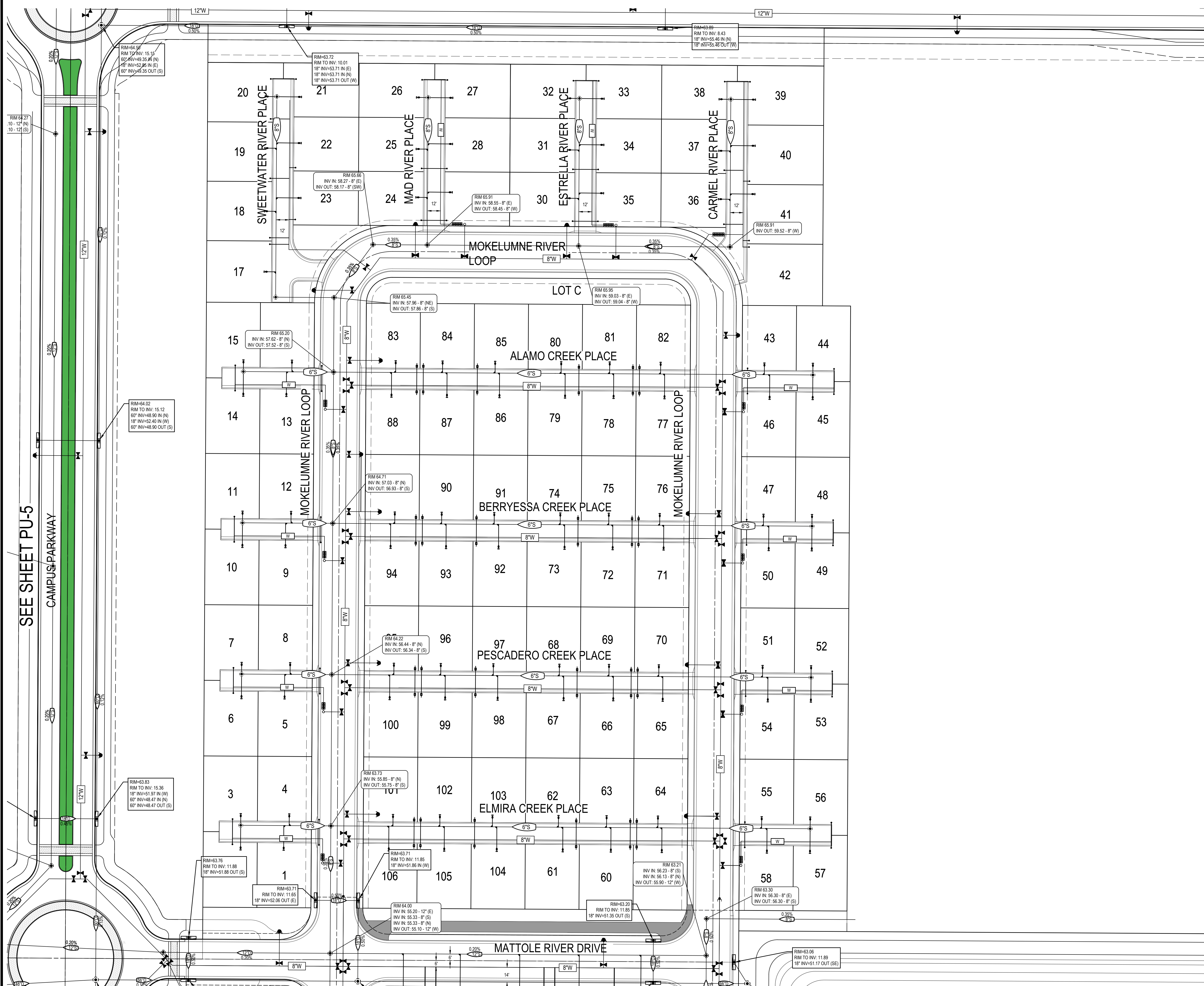

VILLAGE 2
SEE SHEET PU-3

LEGEND

SYMBOLS:		
EXISTING	PROPOSED	DESCRIPTION
		STORM DRAIN PIPE & SIZE
		SANITARY SEWER PIPE & SIZE
		DOMESTIC WATER PIPE & SIZE
		FIRE PROTECTION WATER PIPE & SIZE
		NATURAL GAS PIPE & SIZE
		MANHOLE
		STORM DRAIN INLET
		CLEANOUT
		VALVE
		FIRE HYDRANT
		BLOW OFF VALVE

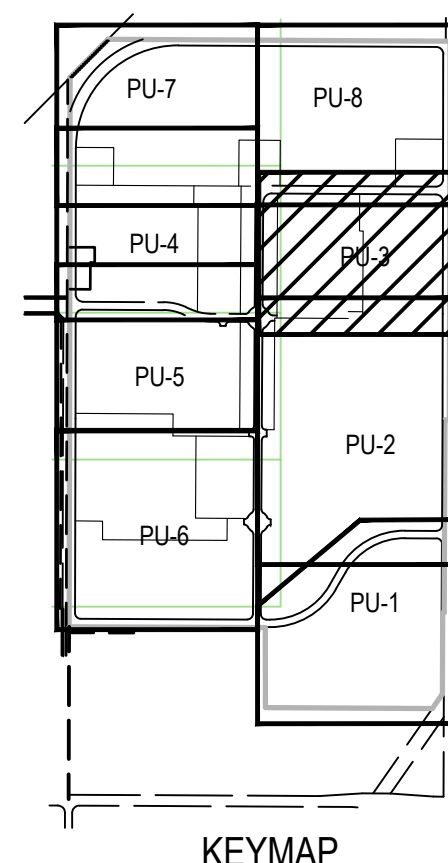
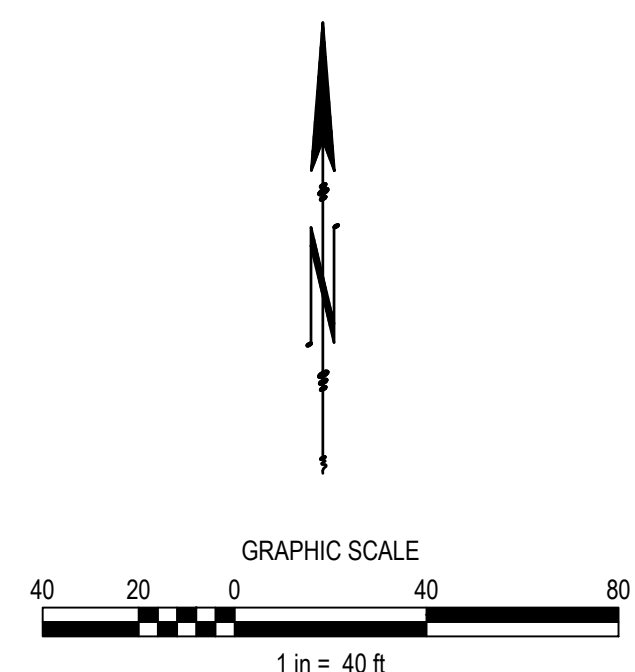

SCALE: 1" = 40'
HORIZ. 1" = _____
VERT. 1" = _____

BENCH MARK
7/8" METAL DISC STAMPED "00, BM, 19-35"
(LOCATED IN TOP OF S.E. END OF S.W. CONCRETE
HEADWALL OF CULVERT ACROSS THE SPRR, 5
APPROXIMATELY 50' N.E. OF CENTER OF
PLACERVILLE ROAD, N.E. OF OLD STATE CULVERT
APX=50' 35" PACES N.W. OF MILEPOST 118 &
APPROXIMATELY 0.45 MILES N.W. OF U.S. ROUTE 50
(R.R. CULVERT BUILT IN 1916)

COMPUTED
DESIGNED
DRAWN
PROJ. ENGR.

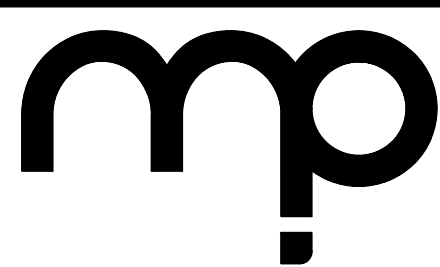

MORTON & PITALO, INC.
CIVIL ENGINEERING • LAND PLANNING • LAND SURVEYING
Folsom • Fresno
600 Coolidge Drive, Suite #140
Folsom, CA 95630
phone: (916) 984-7621
web: www.mpeinc.com

THE CAMPUS @ DIXON
VILLAGE 3 - PRELIMINARY UTILITIES

DATE
03/11/2025
SHEET
PU-4
OF
9

SEE SHEET PU-8



VILLAGE 6
SEE SHEET PU-6

LEGEND

EXISTING	PROPOSED	DESCRIPTION
		STORM DRAIN PIPE & SIZE
		SANITARY SEWER PIPE & SIZE
		DOMESTIC WATER PIPE & SIZE
		FIRE PROTECTION WATER PIPE & SIZE
		NATURAL GAS PIPE & SIZE
		MANHOLE
		STORM DRAIN INLET
		CLEANOUT
		VALVE
		FIRE HYDRANT
		BLOW OFF VALVE

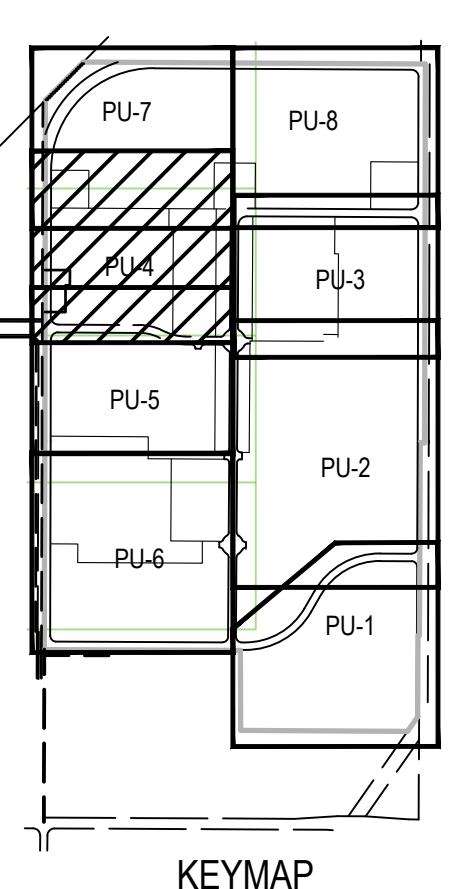
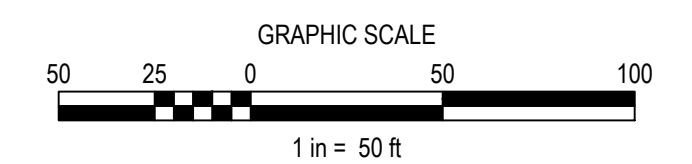

SCALE: 1" = 50'
HORIZ. 1" =
VERT. 1" =

BENCH MARK
7/8" METAL DISC STAMPED "00, BM, 19-35"
LOCATED IN TOP OF S.E. END OF S.W. CONCRETE
HEADWALL OF CULVERT ACROSS THE SPRR, 5
APPROXIMATELY 50' N.E. OF CENTER OF
PLACERVILLE ROAD, N.E. OF OLD STATE CULVERT
APPROX. 35 PACES N.W. OF MILEPOST 118 &
APPROXIMATELY 0.45 MILES N.W. OF U.S. ROUTE 50
(R.R. CULVERT BUILT IN 1916)

COMPUTED
DESIGNED
DRAWN
PROJ. ENGR.



MORTON & PITALO, INC.
CIVIL ENGINEERING • LAND PLANNING • LAND SURVEYING
Folsom • Fresno
600 Coolidge Drive, Suite #140
Folsom, CA 95630
phone: (916) 964-7621
web: www.mpsengr.com

THE CAMPUS @ DIXON
VILLAGE 4 & 5 - PRELIMINARY UTILITIES

DATE 03/11/2025
SHEET PU-5
OF 9

VILLAGE 4 & 5
SEE SHEET PU-5

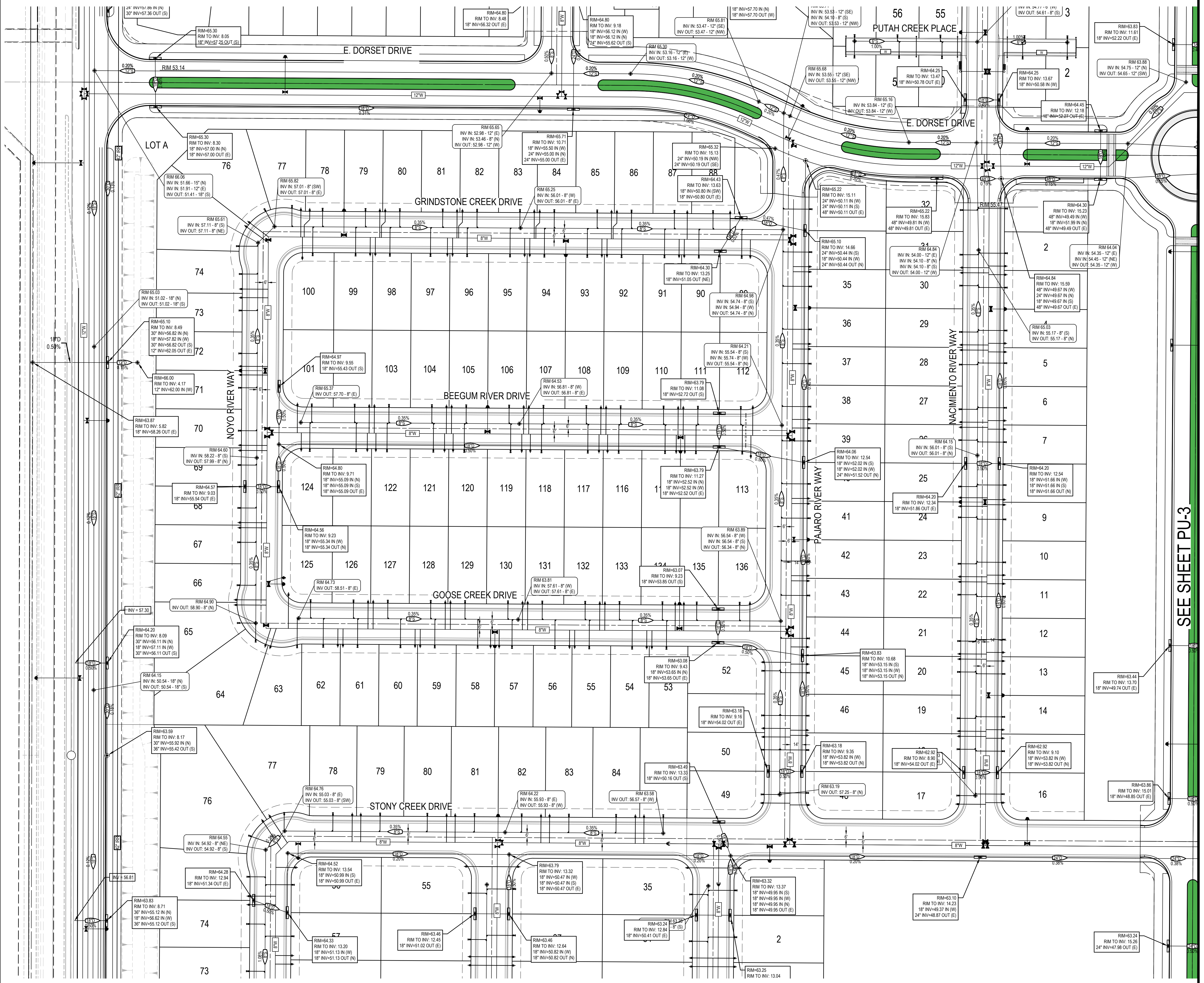

VILLAGE 7 & 8
SEE SHEET PU-7

LEGEND

SYMBOLS:		DESCRIPTION
EXISTING	PROPOSED	
		STORM DRAIN PIPE & SIZE
		SANITARY SEWER PIPE & SIZE
		DOMESTIC WATER PIPE & SIZE
		FIRE PROTECTION WATER PIPE & SIZE
		NATURAL GAS PIPE & SIZE
		MANHOLE
		STORM DRAIN INLET
		CLEANOUT
		VALVE
		FIRE HYDRANT
		BLOW OFF VALVE

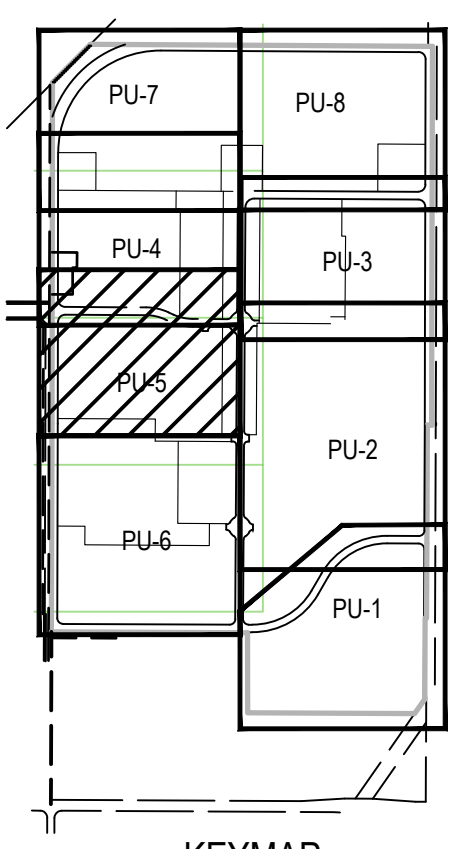
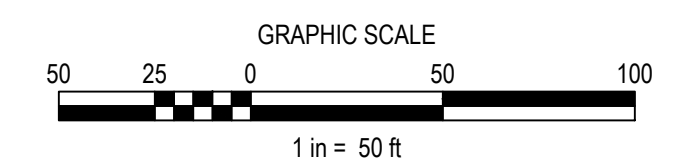

SCALE: 1" = 50'
 HORIZ. 1" =
 VERT. 1" =

BENCH MARK
 7/8" METAL DISC STAMPED "00, BM, 19-35"
 LOCATED IN TOP OF S.E. END OF S.W. CONCRETE
 RETAINMENT WALL OF CULVERT ACROSS THE SPRR, 5
 APPROXIMATELY 50' N.E. OF CENTER OF
 PLACERVILLE ROAD, N.E. OF OLD STATE CULVERT
 APPROX. 1.55 PACES N.W. OF MILEPOST 118 &
 APPROXIMATELY 0.45 MILES N.W. OF U.S. ROUTE 50
 (R.R. CULVERT BUILT IN 1916)

COMPUTED
 DESIGNED
 DRAWN
 PROJ. ENGR.

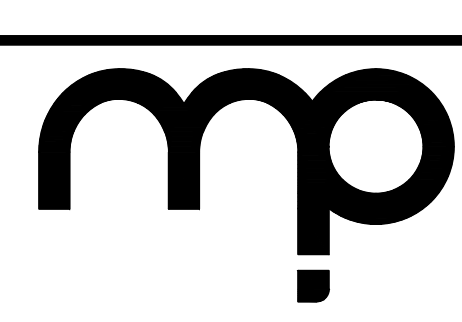

MORTON & PITALO, INC.
 CIVIL ENGINEERING • LAND PLANNING • LAND SURVEYING
 Folsom • Fresno

600 Coolidge Drive, Suite #140
 Folsom, CA 95630
 phone: (916) 954-7621
 web: www.mpeinc.com

THE CAMPUS @ DIXON
 VILLAGE 6 - PRELIMINARY UTILITIES

DATE
 03/11/2025
 SHEET
 PU-6
 OF
 9

VILLAGE 6
SEE SHEET PU-6

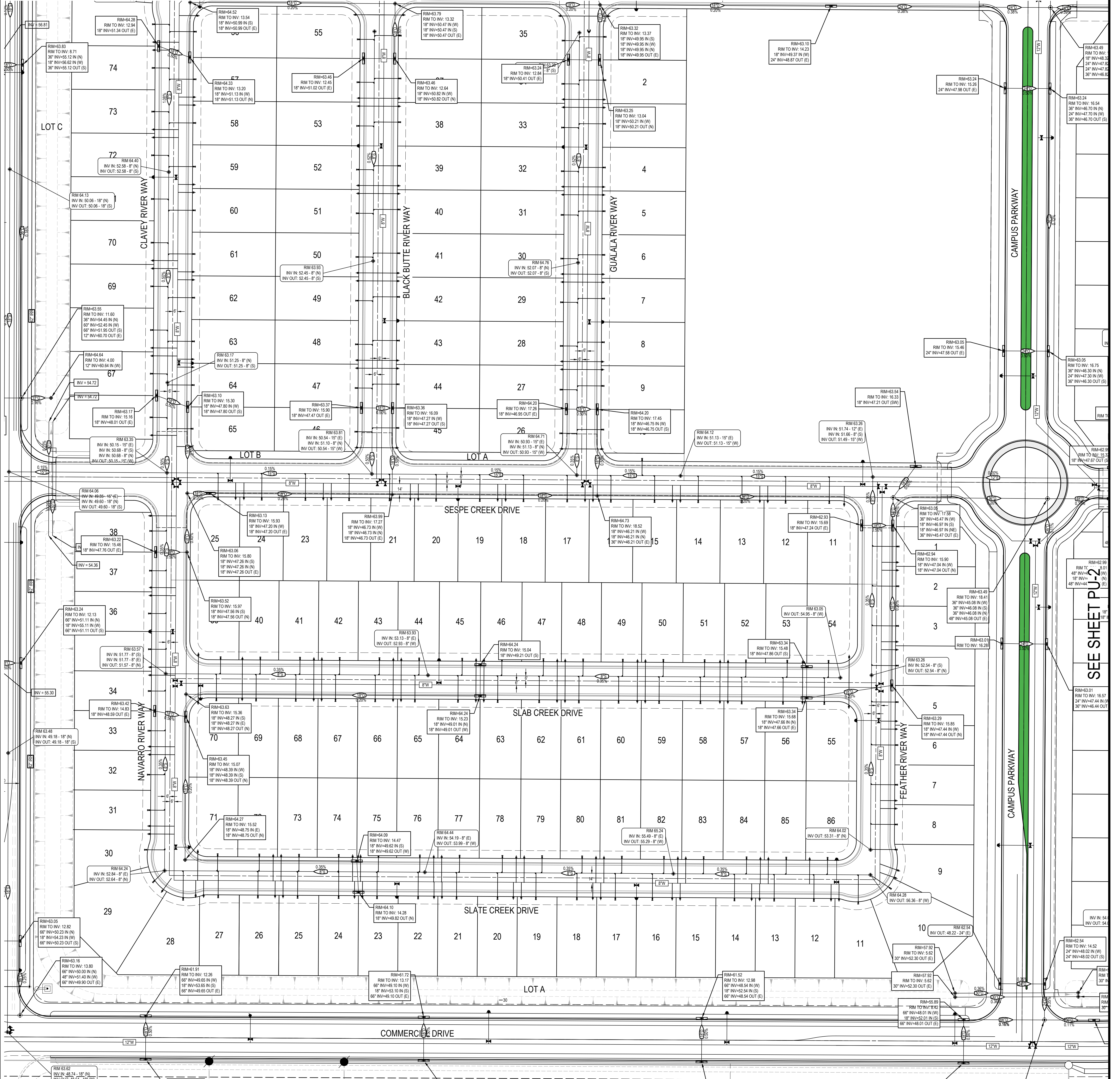

SEE SHEET PU-7

LEGEND

SYMBOLS:	EXISTING	PROPOSED	DESCRIPTION
			STORM DRAIN PIPE & SIZE
			SANITARY SEWER PIPE & SIZE
			DOMESTIC WATER PIPE & SIZE
			FIRE PROTECTION WATER PIPE & SIZE
			NATURAL GAS PIPE & SIZE
			MANHOLE
			STORM DRAIN INLET
			CLEANOUT
			VALVE
			FIRE HYDRANT
			BLOW OFF VALVE

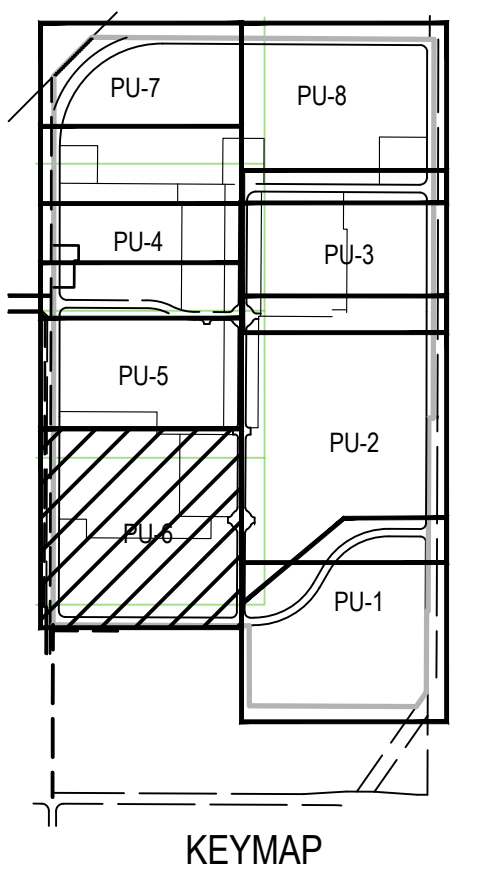
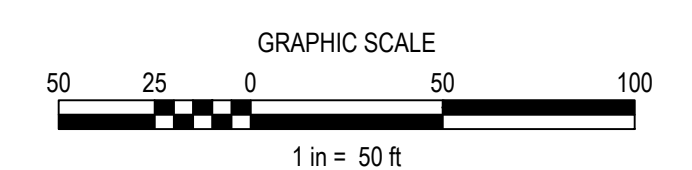

SCALE: 1" = 50'
 HORIZ. 1" =
 VERT. 1" =

BENCH MARK
 7/8" METAL DISC STAMPED "O.D. B.M. 19-35"
 LOCATED IN TOP OF S.E. END OF S.W. CONCRETE
 HEADWALL OF CULVERT ACROSS SPRR, S
 APPROXIMATELY 50' N.E. OF CENTER
 PLACERVILLE ROAD, N.E. OF OLD STATE CULVERT
 APPROX. 15 PACES N.W. OF MILEPOST 116 &
 APPROXIMATELY 0.45 MILES N.W. OF U.S. ROUTE 50
 (R.R. CULVERT BUILT IN 1916)

COMPUTED
 DESIGNED
 DRAWN
 PROJ. ENGR.

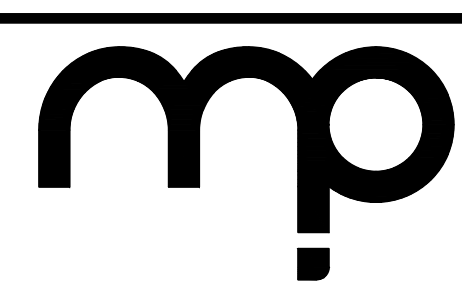

MORTON & PITALO, INC.
 CIVIL ENGINEERING • LAND PLANNING • LAND SURVEYING
 Folsom • Fresno

600 Coolidge Drive, Suite #140
 Folsom, CA 95630
 phone: (916) 964-7621
 web: www.mpeaengr.com

THE CAMPUS @ DIXON
 VILLAGE 7 & 8 - PRELIMINARY UTILITIES

DATE
 03/11/2025
 SHEET
 PU-7
 OF
 9

DIXON OPPORTUNITY CENTER (D.O.C.)

SEE SHEET PU-9

VILLAGE 4 & 5
SEE SHEET PU-5

LEGEND

SYMBOLS:

EXISTING	PROPOSED	DESCRIPTION
		STORM DRAIN PIPE & SIZE
		SANITARY SEWER PIPE & SIZE
		DOMESTIC WATER PIPE & SIZE
		FIRE PROTECTION WATER PIPE & SIZE
		NATURAL GAS PIPE & SIZE
		MANHOLE
		STORM DRAIN INLET
		CLEANOUT
		VALVE
		FIRE HYDRANT
		BLOW OFF VALVE

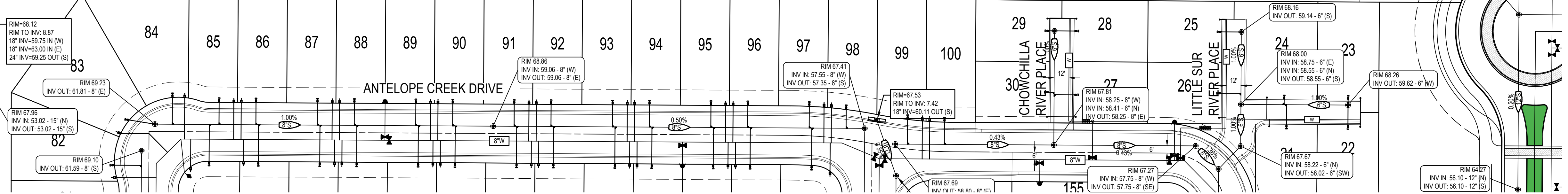
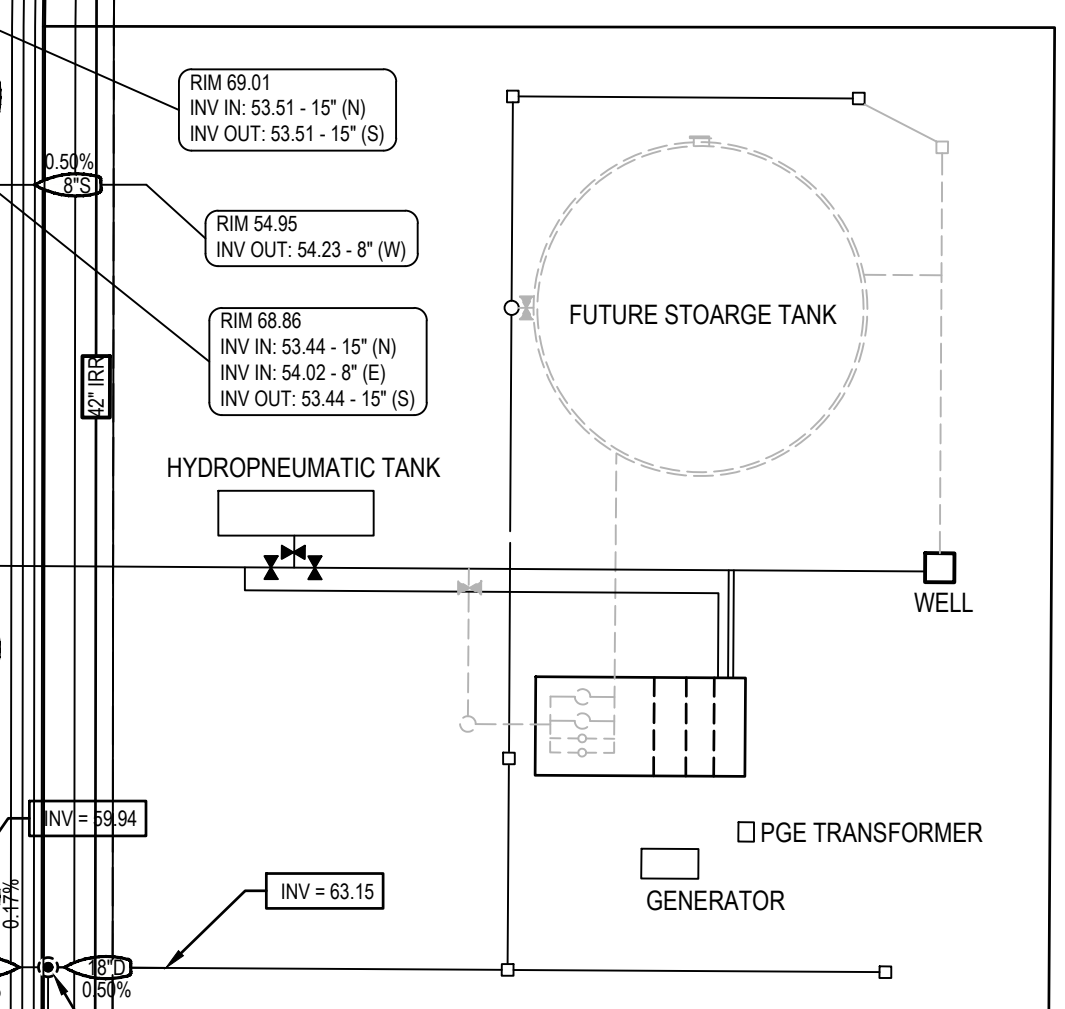
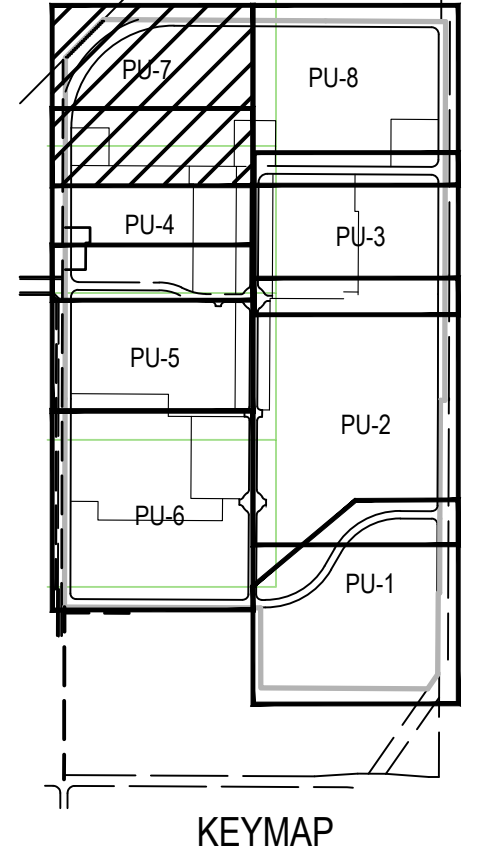
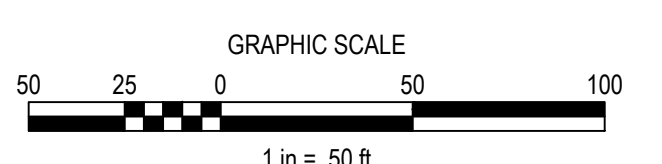

SCALE: 1" = 50'
 HORIZ. 1" =
 VERT. 1" =

BENCH MARK
 7/8" METAL DISC STAMPED "00, D.M. 19-35"
 LOCATED IN TOP OF S.E. END OF S.W. CONCRETE
 HEADWALL OF CULVERT ACROSS THE SPRR, 5
 APPROXIMATELY 50' N.E. OF CENTER OF
 PLACERVILLE ROAD, N.E. OF OLD STATE CULVERT
 APPROX. 35 PACES N.W. OF MILEPOST 116 &
 APPROXIMATELY 0.45 MILES N.W. OF U.S. ROUTE 50
 (R.R. CULVERT BUILT IN 1916)

COMPUTED
 DESIGNED
 DRAWN
 PROJ. ENGR.

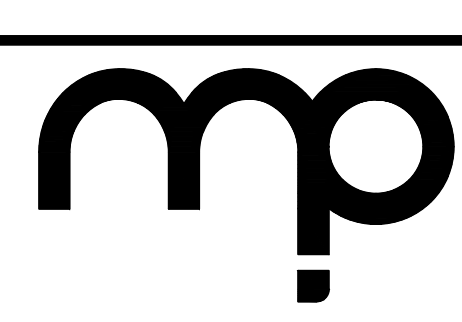

MORTON & PITALO, INC.
 CIVIL ENGINEERING • LAND PLANNING • LAND SURVEYING
 Folsom • Fresno
 600 Coolidge Drive, Suite #140
 Folsom, CA 95630
 phone: (916) 964-7621
 web: www.mppengr.com

THE CAMPUS @ DIXON
 D.O.C. - PRELIMINARY UTILITIES

DATE 03/11/2025
 SHEET PU-8
 OF 9

SEE SHEET PU-5

DIXON OPPORTUNITY CENTER (D.O.C.)

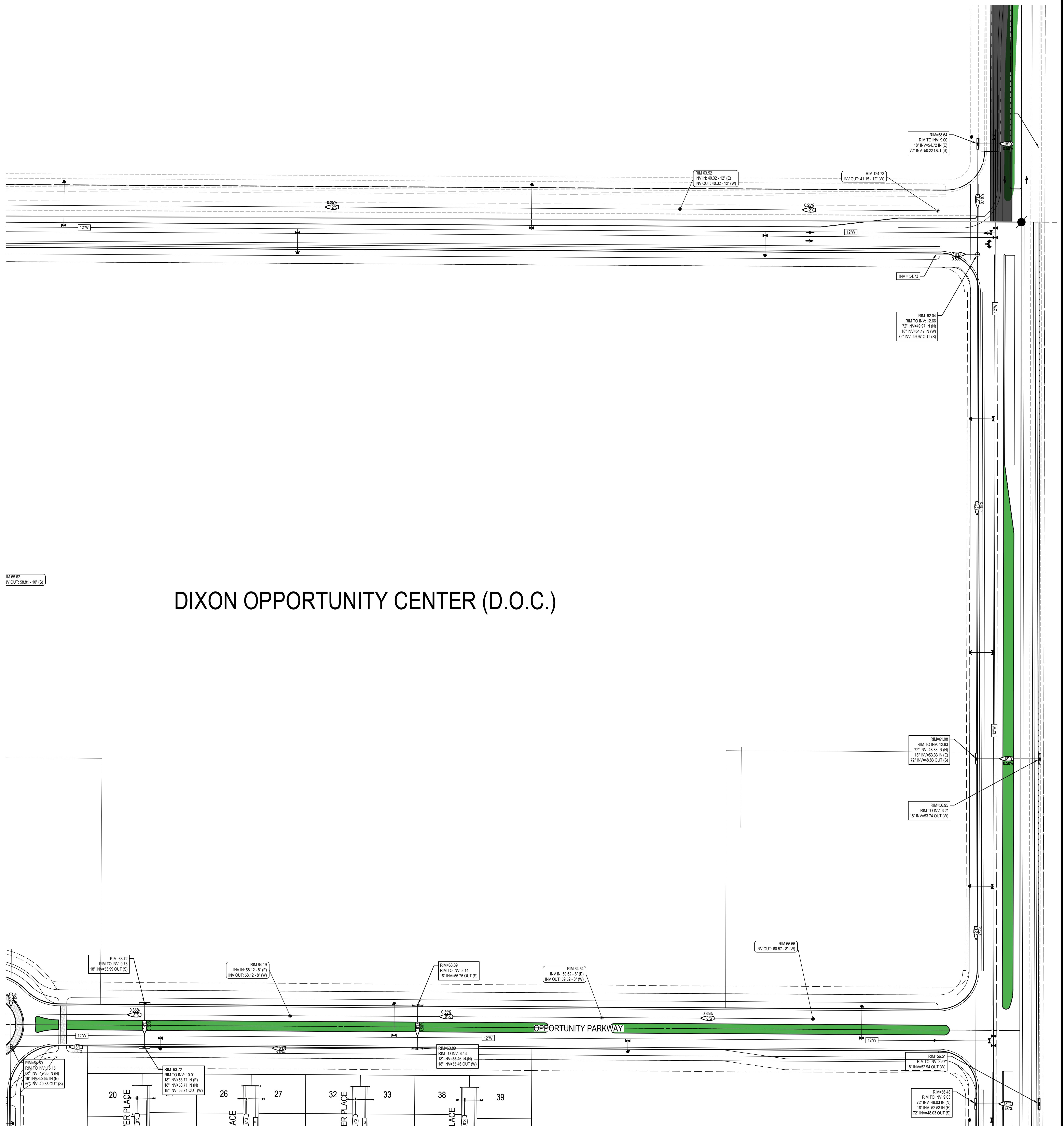

VILLAGE 3
SEE SHEET PU-4

LEGEND

SYMBOLS:		
EXISTING	PROPOSED	DESCRIPTION
		STORM DRAIN PIPE & SIZE
		STORM DRAIN PIPE & SIZE
		SANITARY SEWER PIPE & SIZE
		SANITARY SEWER PIPE & SIZE
		DOMESTIC WATER PIPE & SIZE
		DOMESTIC WATER PIPE & SIZE
		FIRE PROTECTION WATER PIPE & SIZE
		FIRE PROTECTION WATER PIPE & SIZE
		NATURAL GAS PIPE & SIZE
		MANHOLE
		STORM DRAIN INLET
		CLEANOUT
		VALVE
		FIRE HYDRANT
		BLOW OFF VALVE

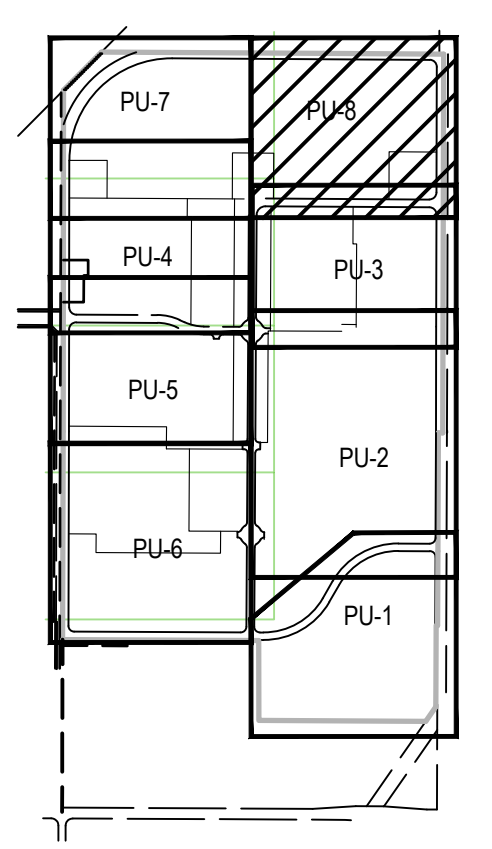
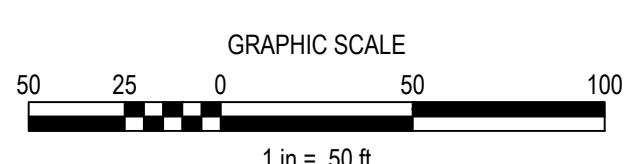

SCALE: 1" = 50'
 HORIZ. 1" =
 VERT. 1" =

BENCH MARK
 7/8" METAL DISC STAMPED "00, D.M. 19-35"
 LOCATED IN TOP OF S.E. END OF S.W. CONCRETE
 HEADWALL OF CULVERT ACROSS THE SPRR, 5
 APPROXIMATELY 50' N.E. OF CENTER OF
 PLACERVILLE ROAD, N.E. OF OLD STATE CULVERT
 APPROX. 35 PACES N.W. OF MILEPOST 118 &
 APPROXIMATELY 0.45 MILES N.W. OF U.S. ROUTE 50
 (R.R. CULVERT BUILT IN 1916)

COMPUTED
 DESIGNED
 DRAWN
 PROJ. ENGR.

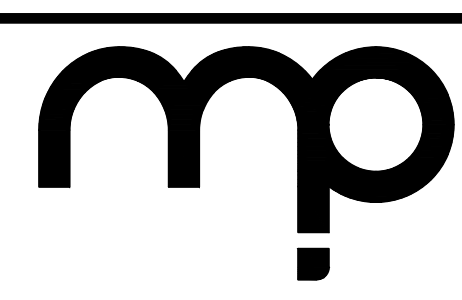

MORTON & PITALO, INC.
 CIVIL ENGINEERING • LAND PLANNING • LAND SURVEYING
 Folsom • Fresno

600 Coolidge Drive, Suite #140
 Folsom, CA 95630
 phone: (916) 964-7621
 web: www.mppengr.com

THE CAMPUS @ DIXON
 D.O.C. - PRELIMINARY UTILITIES

DATE 03/11/2025
 SHEET PU-9
 OF 9